

PRO UNI-D CO., LTD.

5 way motorized control valve instruction and manual

1. Products instruction

5way motorized control valve used to control filtering water system / tank. Use a control box to control function filtering, backwashing, Rinsing. 5way valve design to simplify piping, make connecting easily and save cost.

2. Product Characteristics

- Manual operating: users can stop or reset functions directly through the switch on control box. When power fail, users can use manual override (or hand wheel) on actuator to close the valve.
- When power fail, the control box can keep setting for 5days, after 5days, users need to reset the control box.
- The control box provide days and hours for setting function operating automatically.
- 12 times backwash max. per day.

3. Installation and piping

Piping

- Ambient temperature: $+5^{\circ}\text{C} \sim +80^{\circ}\text{C}$, keep away from high temperature (over 80°C .)
- Connect pipes according to diagram as following:
 - (i) The port (A) is for output clean water;
 - (ii) The port (B) is connected to tank (input water) ;
 - (iii)The port (C) is for output waste water;
 - (v) The port (D) is for in/output clean or waste water, based on rinsing or filtering function.

※ The position of control valve should higher than drain output port.

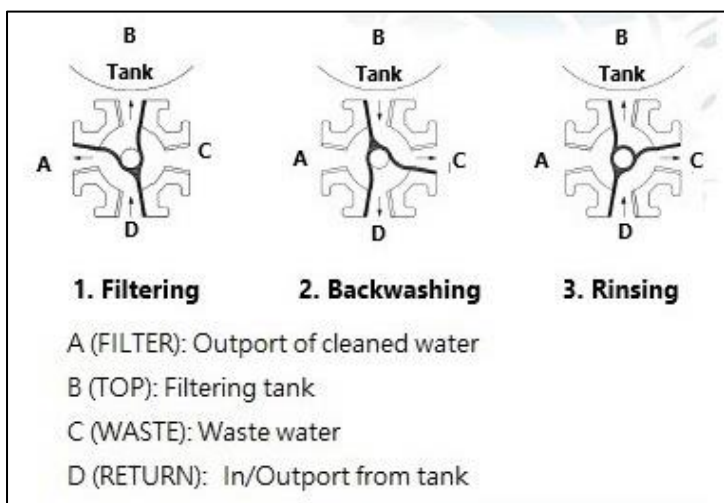
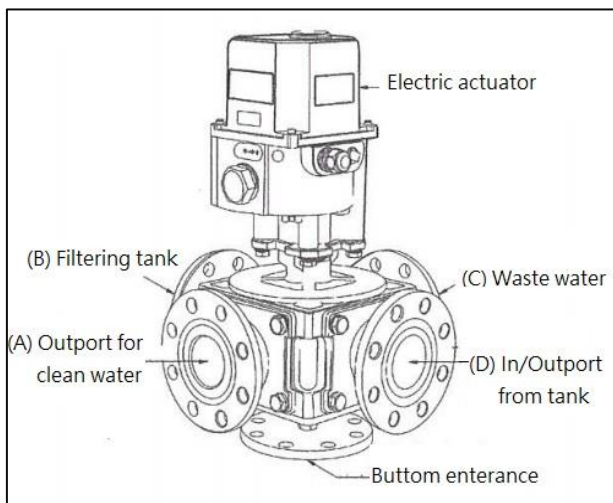

PRO UNI-D CO., LTD.

Installation (1): 5 WAY CONTROL VALVE

UM-3 3 section control valve

Wiring diagram (actuator)

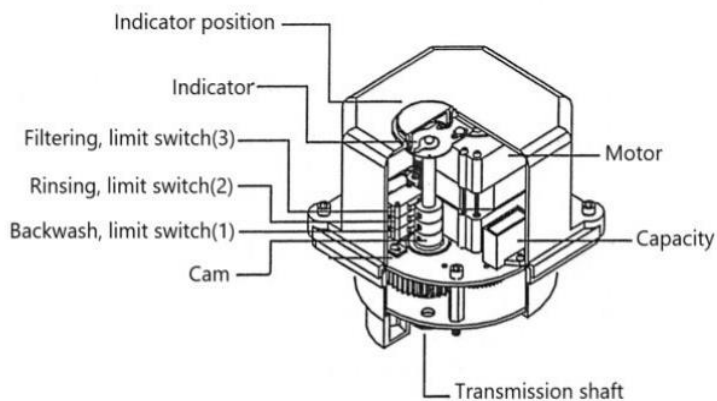
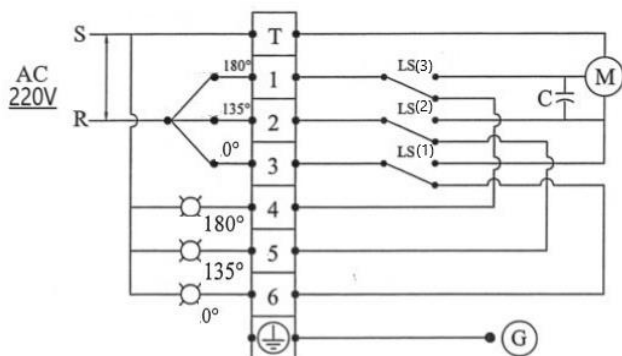

Cam movement drawing

Adjust tools: Hexagonal head wrench(2.5H)x1

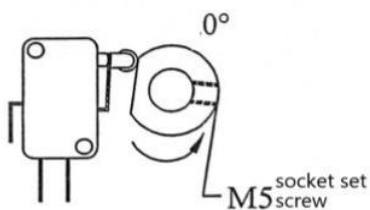

Filtering, limit switch(3)

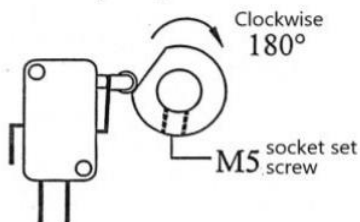

Backwash, limit switch(1)

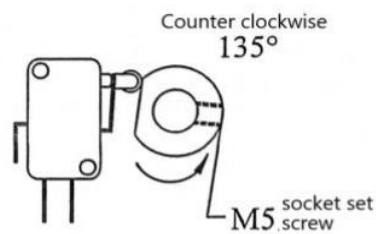

Rinsing, limit switch(2)

Control step:

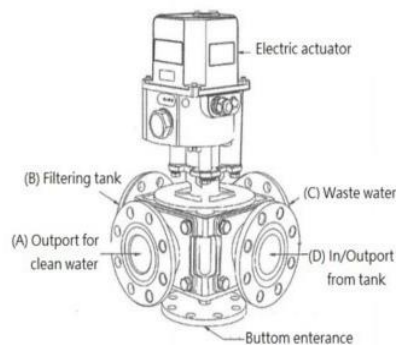
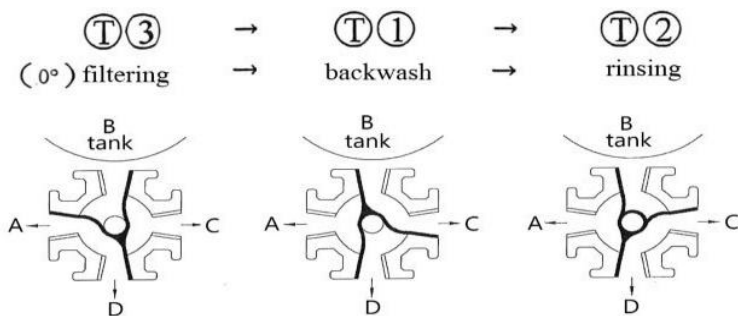

1. Power on, the indicator will stay at 0° then turn clockwise 180° to run "backwash" function.
2. After "backwash" be completed, the indicator turns counter clockwise 135° to run "rinsing" function.
3. After "rinsing" be completed, the indicator turns counter clockwise 45° back to 0°.

PRO UNI-D CO., LTD.

Control box timer setting:

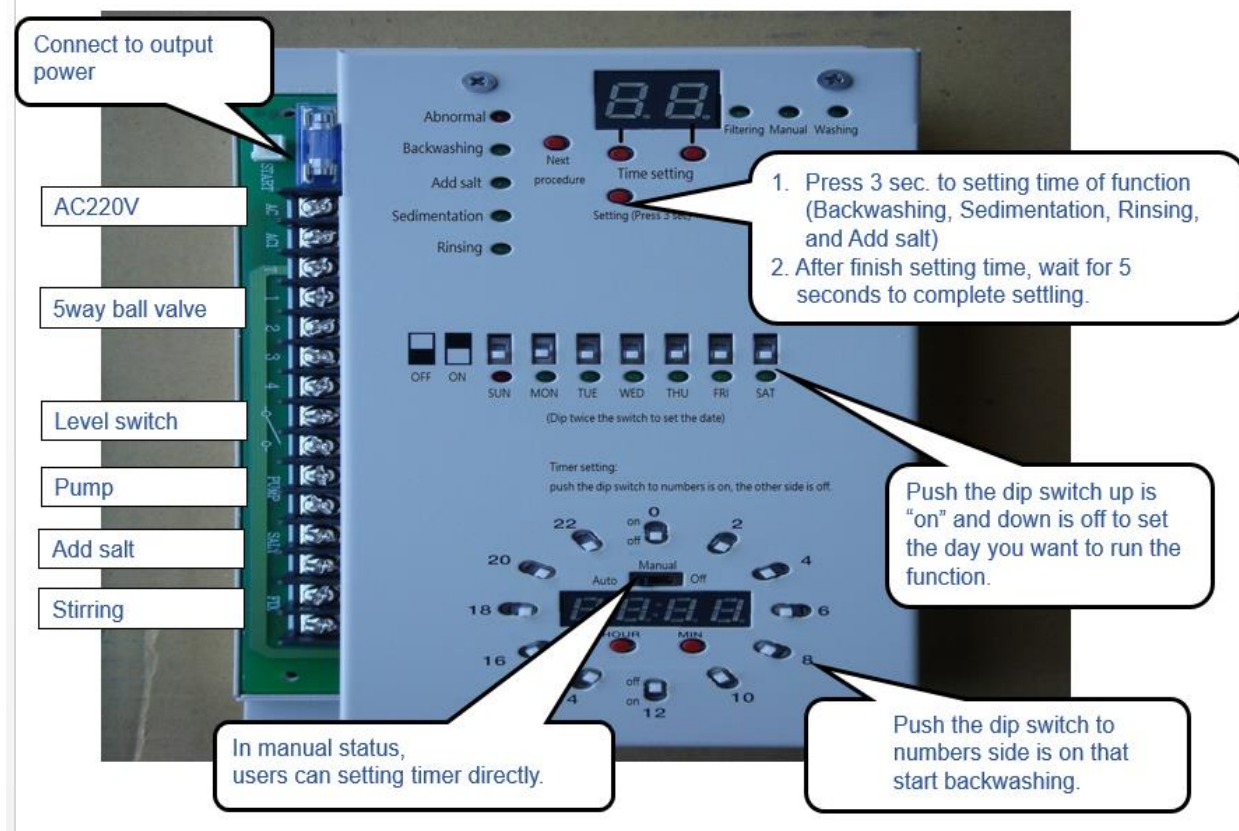

Timer setting			
Function	available range (minutes)	Factory pre-setting (minutes)	Modification method
Backwashing	0~99	4	Press the "Time setting" button 3 seconds to start setting.
Salting	0~99	0	
Precipitation	0~99	0	
Rinsing	0~99	3	

*If user would like to use factory pre-setting, just press the "Time setting" button and re-start the power again.

PRO UNI-D CO., LTD.

Test operation status

Wiring according to wiring diagram:

1. If wiring with check valve (as photo below), it should be installed in correct direction between the pump and the 5way motorized control valve.
2. Recommend to install a flow-regulating valve at the clean water output of the electric 5way motorized control valve to adjust water flow, the water flow slower, the filtered water will be clearer.
3. Before turn on the power, make sure the Manual switch is set at "AUTO" status.

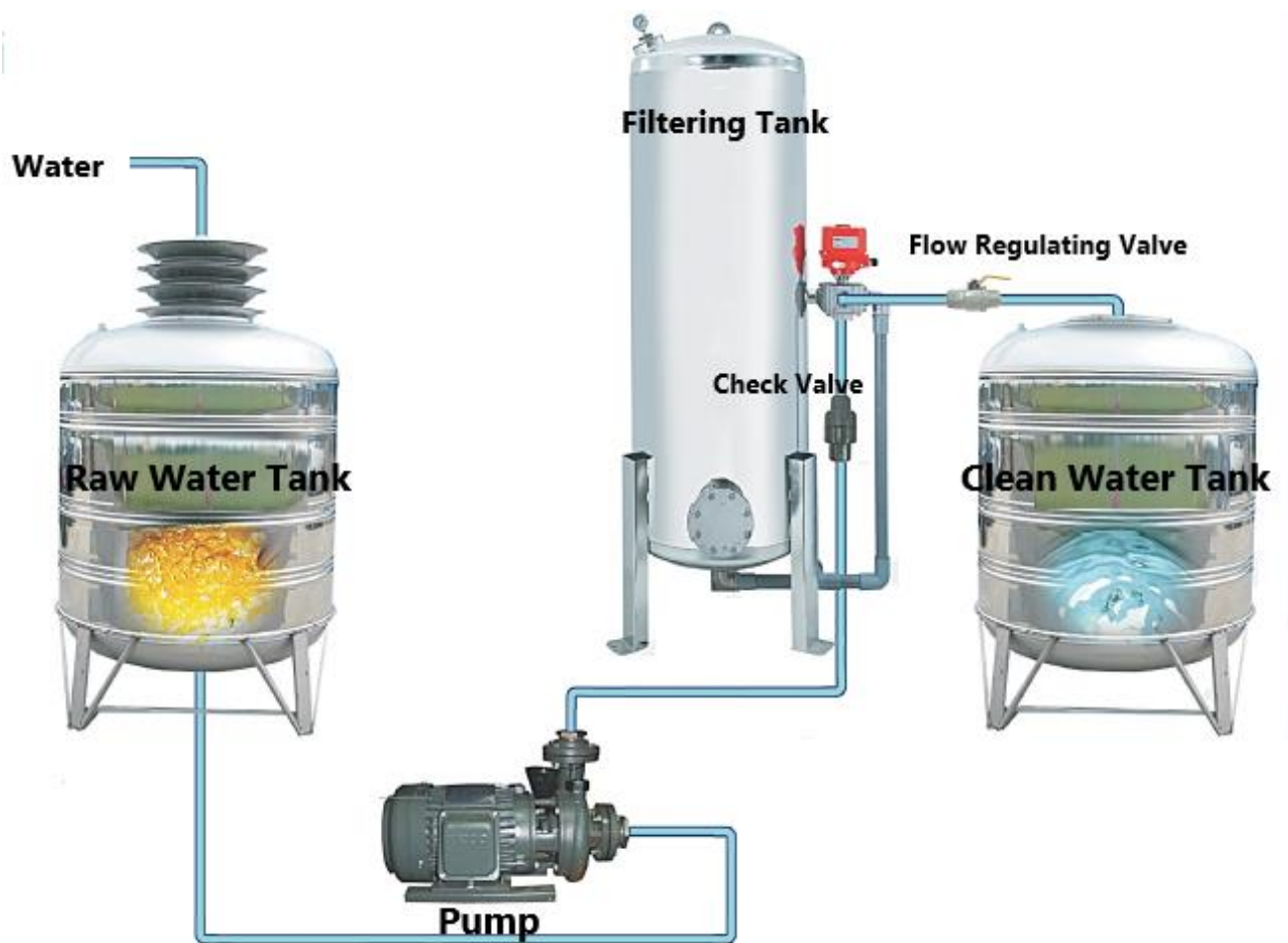

EXAMPLE WIRING DIAGRAM

No.7, Ruei Yuan Street, Bade Dist.,
Taoyuan City 33447, Taiwan (R.O.C.)
TEL:886-3-3682323 FAX:886-3-3680977
E-mail : unid@unid.com.tw
grace377@unid.com.tw

miT-**UniD**[®]-cns

PRO UNI-D CO., LTD.

Installation (2) CONTROL BOX

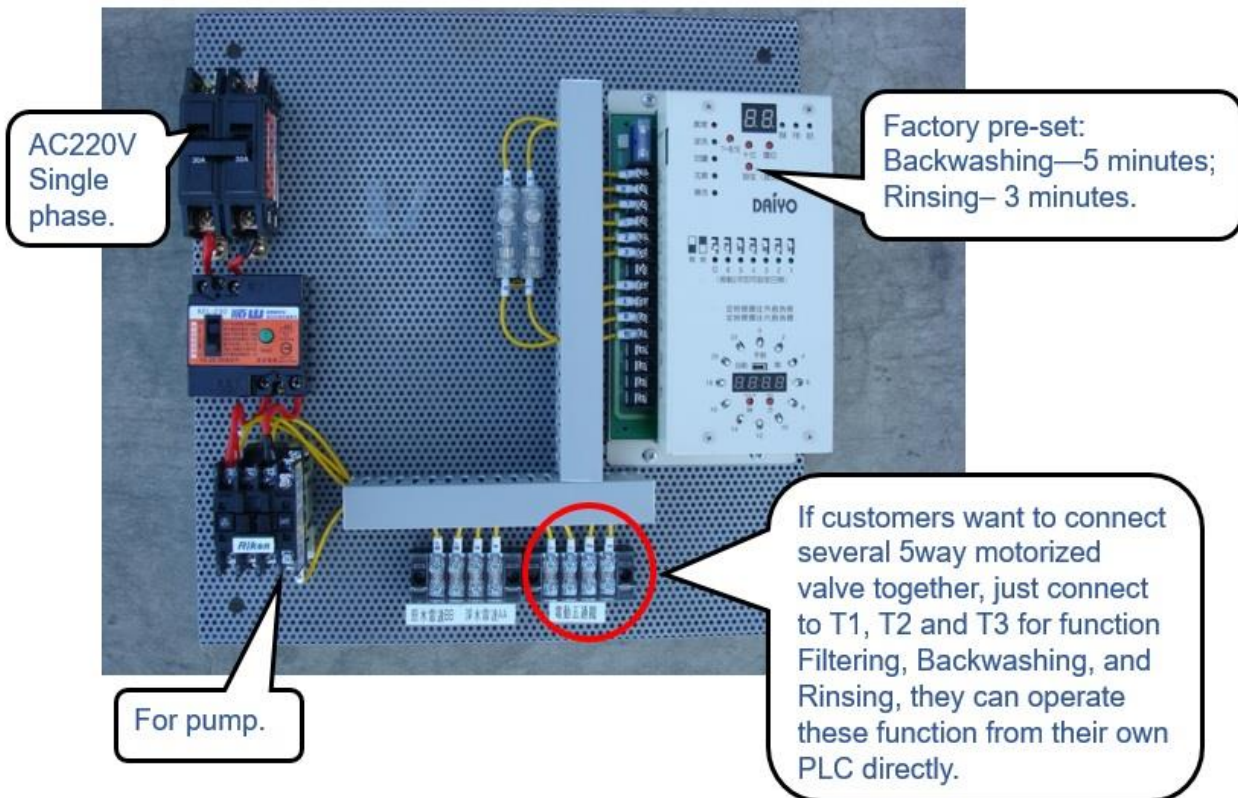

No.7, Ruei Yuan Street, Bade Dist.,
Taoyuan City 33447, Taiwan (R.O.C.)
TEL:886-3-3682323 FAX:886-3-3680977
E-mail : unid@unid.com.tw
grace377@unid.com.tw

miT-**uniD**-cns