

PRO UNI-D CO., LTD.

● 三通球閥 / Three Ways Ball Valve

Item : JP-690

Size : 1/2" ~ 2"

Joint End : Socket (ANSI/CNS/DIN/JIS)
Threaded (PT/NPT/BSPF)

Working Pressure: 150 PSI

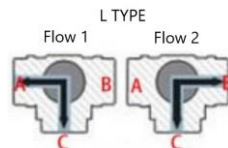
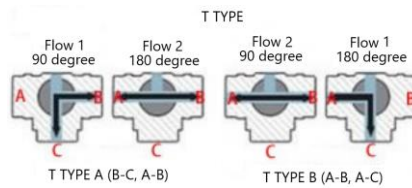
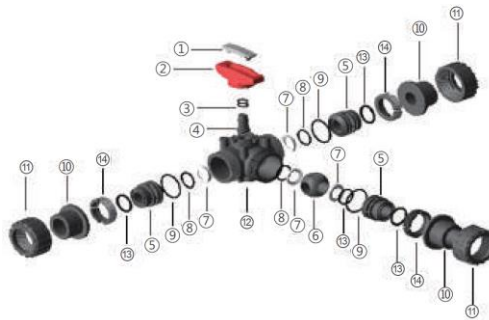
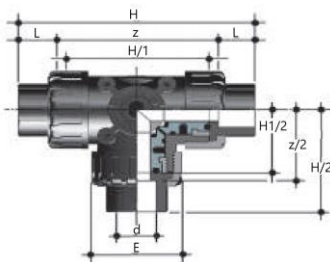
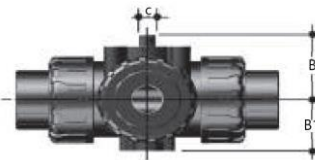

NO.	PART	MATERIAL	Q'TY
1	Cap	PVC	1
2	Handle	PVC	1
3	O-ring	EPDM/ VITON	2
4	Stem	PVC	1
5	Seal Carrier	PVC	3
6	Ball	PVC	1
7	Seat Seal	PTFE	4
8	O-ring	EPDM/ VITON	4
9	O-ring	EPDM/ VITON	3
10	End Connector	PVC	3
11	Union Nut	PVC	3
12	Body	PVC	1
13	O-ring	EPDM/ VITON	3
14	Snap ring	PVC	3

Unit: mm

Nom. Size	D	L	H1	H2	L1	L2	L3	W	I	F	E	UM no.
DN15 (1/2")	53.8	110.2	49.3	27.5	21.8	68.0	55.8	75.0	M6	31.0	69.0	UM-1
DN20 (3/4")	64.8	120.2	63.0	33.5	25.4	70.5	59.6	92.0	M6	33.0	69.0	UM-1
DN25 (1")	76.0	138.5	73.0	39.0	27.8	83.5	73.5	93.8	M6	40.0	82.2	UM-1
DN32 (1-1/4")	85.8	162.8	86.0	43.5	32.0	92.0	82.0	110.0	M8	45.0	82.2	UM-2-5
DN40 (1-1/2")	91.5	170.0	95.5	48.0	28.0	98.0	87.0	115.0	M8	52.0	117.0	UM-2-5
DN50 (2")	122.0	205.0	113.0	62.0	38.0	126.0	115.0	146.0	M8	70.0	117.0	UM-2-5

Nom. Size	d				B	B1	C	H	H1	Z	L	H1/2	Z/2	H/2	L1	L2	Operating torque (N.M.) / ISO
	ANSI	DIN	JIS	CNS													
DN15 (1/2")	21.54	20.30	22.30	22.40	51	38.5	69	138	83	119	22.5	54.5	59.5	81.5	26	18	3.5 (F03)
DN20 (3/4")	26.87	25.30	26.30	26.40	51	38.5	69	172	109	123	24.5	54.5	61.5	86	26	18	3.5 (F03)
DN25 (1")	33.65	32.30	32.33	34.50	58	46	82	200	130	144	28	65	72	100	26	18	4.5 (F03)
DN32 (1-1/4")	42.42	40.30	38.43	42.50	58	46	82	208	130	144	32	65	72	104	26	18	4.5 (F03)
DN40 (1-1/2")	48.56	50.30	48.46	48.60	110	64	-	240	154	171	34.5	77	85.5	120	50	30	5.5 (F07)
DN50 (2")	60.63	63.30	60.56	60.60	110	64	-	246	154	171	37.5	77	85.5	123	50	30	5.5 (F07)